

DLC6065/90 Contact Readers



General Description

The DLC6065/90-M CCD contact readers fulfill the most common retail and office automation needs, by offering excellent reading performance and reliability with a low price. In fact, these products guarantee the most powerful characteristics on the market for readers in their class, and represent an ideal entry-level solution for Point Of Sale applications.

The DLC6065/90-M reading performance, thanks to excellent optics and the Software Focus Level System, is outstanding in terms of reliability on high and low density codes even of poor quality and applied on curved or uneven surfaces.

Reading aggressiveness is also enhanced by the readers' depth of field, from contact to 5 cm, which allows proximity image acquisition without any risk of misreading codes placed very close to each other.

One of the important features provided by the Datalogic CCD series is a multistandard interface mounted on board. Connection to RS232, Wedge and Pen emulation can be obtained using just a single unit, by simply changing the plug-in cables. The main benefits of this feature are: stock savings, faster delivery and, for the end user, long-term investment protection due to the peripheral that adapts to changes in the system.

Features

- > 65 and 90 mm reading window
- > Advanced decoding Libraries with SFLS (SW Focus Level System)
- > MULTISTANDARD ARCHITECTURE

Applications

- > Data collection in commercial and office automation environments
- > Data collection in light industrial environments

Specifications

ELECTRICAL CHARACTERISTICS

POWER SUPPLY +5 VDC \pm 5%
Directly from the terminal or PC in wedge and pen mode, or via an external PG5 power supply in RS232 mode

CONSUMPTION 150 mA max.

MECHANICAL CHARACTERISTICS

DIMENSIONS 164 x 77.5 x 63 mm (DLC6065-M)
175 x 100 x 80 mm (DLC6090-M)

WEIGHT (approx.) 160 g (DLC6065-M)
195 g (DLC6090-M)

CASE MATERIAL ABS

CABLE LENGTH 2 m (6.6 ft) linear

PERFORMANCE

LIGHT SOURCE Visible red LED

MAX. RESOLUTION 0.1 mm (DLC6065)
0.13 mm (DLC6090)

SCAN RATE 100 scans/sec

PRINT CONTRAST RATIO 15% (min)

READING FIELD 65 mm (DLC6065)
88 mm (DLC6090)

READING DISTANCE 0 to 50 mm on EAN 13 code MAG1

READABLE BAR CODES 2/5 family, Code 39, Code 32, Code CIP 39, Code 128, EAN128, EAN/UPC, ISBN/ISSN, CODABAR, Code 93

READING INDICATORS LED and adjustable tone "beeper"

READING MODE Single or autodiscrimination code

PROGRAMMING METHOD

Manual

Reading special bar codes

Automatic (with RS232)

S/W commands through the serial port

Sm@rtSet

Windows configuration program

INTERFACES

RS232, Pen Emulation, Wedge (PC IBM XT/AT/PS2, IBM SureOne,

Notebook, IBM terminals: 31xx, 32xx, 34xx, 37xx, 3153)

RS232, IBM 468x and 469x

DLC6065/90 I1

ENVIRONMENT

AMBIENT LIGHT CONDITIONS 30,000 lux max. (contact with code surface)

OPERATING TEMPERATURE 0 to 55 °C

STORAGE TEMPERATURE -20 to 70 °C

HUMIDITY 90% non condensing

DROP RESISTANCE IEC 68-2-32 Test ED

ENVIRONMENTAL PROTECTION IP30

Connections

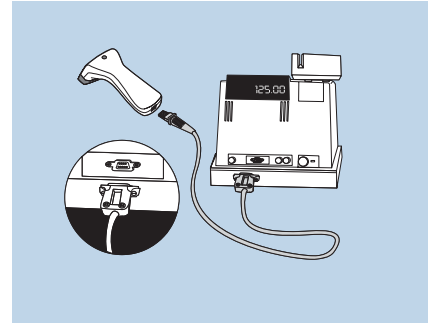

Pen Emulation

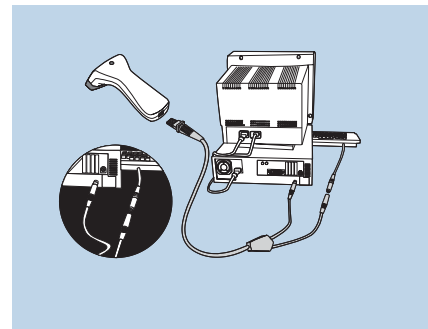

Wedge Emulation

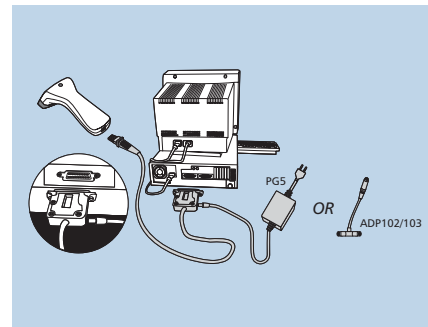

RS232

