

MC35

Quick Start Guide

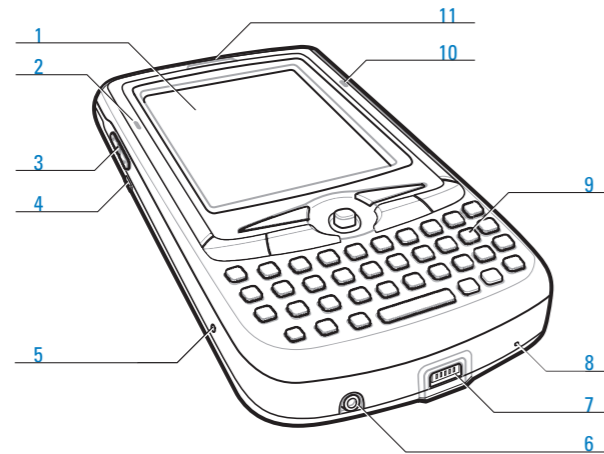

FEATURES



- 1 LCD Touch Screen
- 2 GSM Status/Notification LED
- 3 Volume Up/Down Button
- 4 Camera/Bar Code Switch
- 5 Reset Button
- 6 Earphone Jack
- 7 Connector
- 8 Microphone
- 9 Keypad
- 10 Charging LED
- 11 Phone Speaker

NOTE: To reset the MC35, press the reset button with the tip of the stylus.

- 12 Main Battery
- 13 Speaker
- 14 Camera Lens (Optional)
- 15 Camera Flash (Optional)
- 16 Infrared (IR) Port
- 17 SD/MMC Expansion Slot
- 18 Stylus
- 19 Push To Talk Button
- 20 Power Button
- 21 Camera Button*
- 22 Battery Release Latch

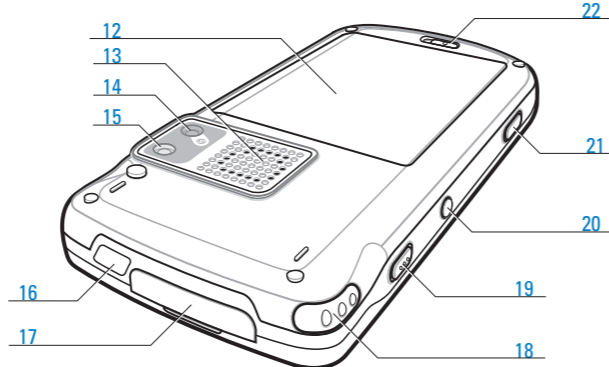

* Programmable on non-camera versions.

KEYPADS

- 1 Send Button
- 2 Start Button
- 3 Left Soft Button
- 4 Joystick
- 5 Right Soft Button
- 6 OK Button
- 7 End Button
- 8 Orange Key
- 9 Star Key
- 10 Backlight/O Key
- 11 Messaging Button

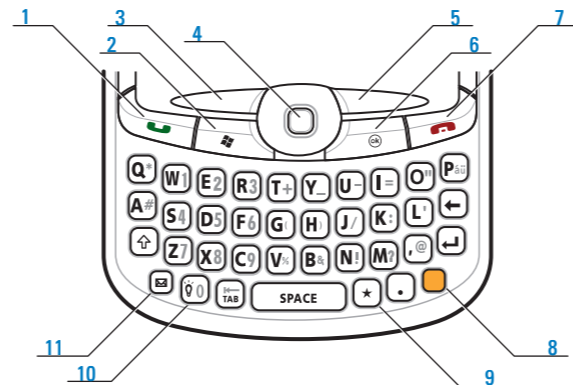

Orange Key

- Use this key to access the secondary layer of characters and actions.
- > Press the key once to activate this mode followed by another key.
- > Press the key twice to lock this mode. Press the key a third time to unlock.
- > Press and hold the key while entering characters or actions.

GETTING STARTED

1 Install the Battery Pack

Align the tabs on the battery pack with the grooves on the MC35, then insert the battery pack into the back of the device.

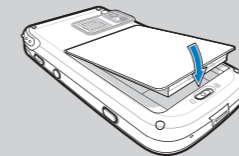

The battery pack locks to the chassis with an audible click.

2 Charge the MC35

NOTE: Use the clip plug applicable in your country.

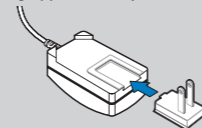

- 1 Install the replaceable clip plug to the AC adapter. Slide the clip plug into the clip plug holder and snap into place. The clip plug locks to the clip plug holder with an audible click.
- 2 Plug the AC adapter cable into the connector on the bottom of the MC35.
- 3 Connect the AC adapter power cable into an electrical outlet.

After the AC connection is made, the charging LED indicator on the front panel lights orange.

LED status during charging:

- Flashing orange: Charging
- Solid orange: Charging complete

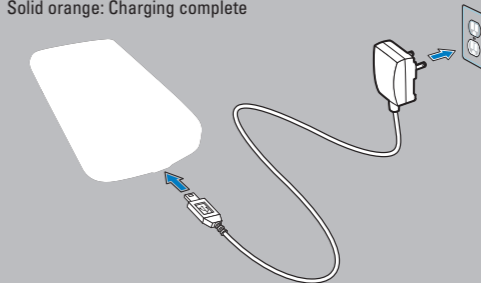

3 Start the MC35

After you have initially charged the MC35 for approximately eight hours, the device is ready for use.

- 1 Turn on the MC35 by pressing the Power button located on the right side of the device.



- 2 Follow the onscreen instructions on the Welcome Screen Wizard.

4 Install ActiveSync

Download ActiveSync 4.0 or higher from <http://www.microsoft.com> and follow the instructions to install ActiveSync onto the host computer.

5 Connect the MC35 to a Host Computer

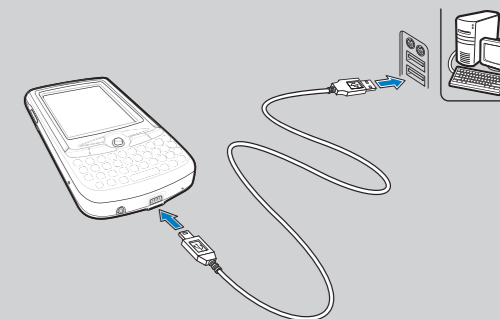

6 Create a Partnership

Follow the onscreen ActiveSync instructions to establish a connection between the MC35 and the computer.

IMPORTANT:

For initial use, charge the MC35 for approximately eight hours. Thereafter, charge the MC35 everyday to recharge the battery to full capacity. Charge the MC35 using the AC adapter cable.

More information on the MC35

Visit the Motorola Web site at <http://www.motorola.com/mc35>

Setting up and using the MC35

MC35 User Guide - <http://support.symbol.com/support/product/MC35.html>
For optimal performance prior to use, visit the following for the latest software:

- Software Updates - <http://support.symbol.com/support/product/MC35.html>
- Hot-fixes - <http://support.symbol.com/support/product/MC35fixes.html>

Product Video Tutorial

Visit the Motorola Web site at <http://www.motorola.com/mc35>

Connecting and synchronizing with the host computer

ActiveSync® Help on the host computer. To view help, start ActiveSync®, click Help - Microsoft ActiveSync Help.

Information on using programs on the MC35

Tap Start – Help within the specific program.

Service and Warranty

MC35 Regulatory Guide

Accessories

- Vehicle Kit
 - Auto Mounting Kit
 - Auto Charger
 - Hands-free Headset
- Leather Case
- USB Charge/Sync Cable
- Travel Charger
- Hands-free Headset
- Protective Boot
- Stylus 3-pack
- Standard Life Battery
- Extended Life Battery



Motorola, Inc.
One Motorola Plaza Holtsville, New York 11742-1300, USA
MOTOROLA and the Stylized M Logo and Symbol and the Symbol logo are registered in the U.S. Patent and Trademark Office. All other product or service names are the property of their respective owners.
© Motorola, Inc. 2008



72-93873-03 Rev. A — August 2008

Install the Memory Card

- 1 Open the expansion slot cover.

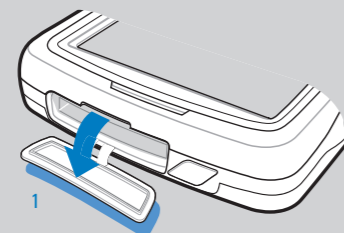

- 2 Slide the SD/MMC card into the slot and push in until it locks into place.

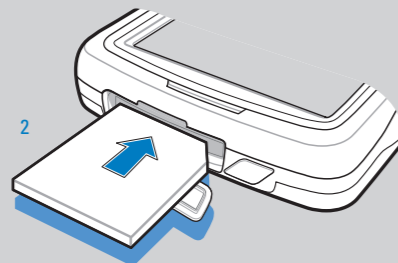

- 3 To remove the SD/MMC card, push down on the card and release. The card ejects from the slot.

1 Install the SIM Card

- 1 Press the Power button to turn off the MC35.
- 2 Slide the battery latch to the unlock icon to remove the battery. The battery pack ejects slightly.
- 3 Remove the battery pack from the MC35.

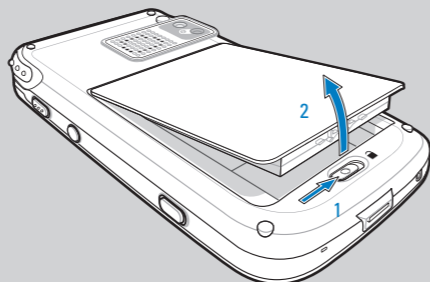

- 3 With rear panel facing you, slide the SIM card holder to the right.
- 4 Lift the holder halfway from the recess area.
- 5 Insert the SIM card into SIM card holder.

NOTE:

The proper position of the SIM card—the card connector (i.e., gold area) should be facing downward with the bevelled corner fitting the lower left corner of the recess area.

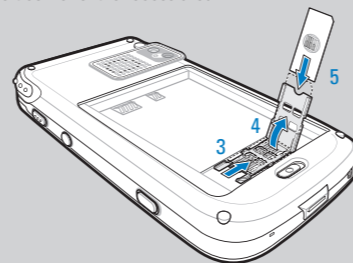

- 6 Press the SIM card holder down.
- 7 Slide the SIM card holder to the left to lock it into place.

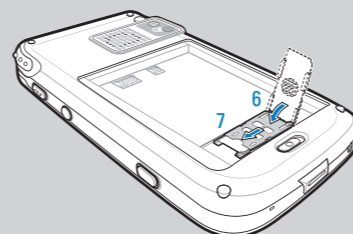

- 8 Reinstall the battery pack.

2 Enter Your PIN

After installing the SIM card activate your mobile service connection. In most cases, SIM cards are preset with a PIN (Personal Identity Number), provided by your service provider.

- 1 Press the Power button to turn on the MC35.
- 2 Tap Start > Phone.
- 3 Enter the PIN from your service provider.
- 4 Tap Enter.

3 Turn On the Phone Function

- 1 Launch the Wireless Manager application.
 - On the Today screen, tap the Wireless Manager icon. or
 - On the Today screen, tap the signal icon and select Wireless Manager.
- 2 On the Wireless Manager screen, tap Phone to turn on the phone function. The signal icon changes indicating the MC35 is searching for a mobile connection. This may take a few seconds. The signal icon changes to and to once a mobile connection is established.

4 Turn Off the Phone Function

- 1 Launch the Wireless Manager application.
 - On the Today screen, tap the Wireless Manager icon. or
 - On the Today screen, tap the signal icon and select Wireless Manager.
- 2 On the Wireless Manager screen, tap Phone to turn off phone function.

Notifications

Charging LED:

- Flashing orange: Battery charging
- Solid orange: Charging complete

GSM Status/Notification LED:

- Fast flashing green: GSM activity
- Solid green: Voice call in progress
- Flashing red: System notification

- 1 Place the Camera/Bar Code switch to the Bar Code position.
- 2 Launch a bar code reading application on MC35.
- 3 Point the MC35 toward the bar code and align if necessary.
- 4 Press the Camera button to read the bar code data.

