

Quick Start Guide

P/N 962-054-034
Revision B
May 2001

Model 70 Pocket PC



A **UNOVA** Company

Intermec Technologies Corporation
6001 36th Avenue West
P.O. Box 4280
Everett, WA 98203-9280

U.S. service and technical support: 1-800-755-5505
U.S. media supplies ordering information: 1-800-227-9947

Canadian service and technical support: 1-800-668-7043
Canadian media supplies ordering information: 1-800-268-6936

Outside U.S. and Canada: Contact your local Intermec service supplier.

The information contained herein is proprietary and is provided solely for the purpose of allowing customers to operate and/or service Intermec manufactured equipment and is not to be released, reproduced, or used for any other purpose without written permission of Intermec.

Information and specifications in this manual are subject to change without notice.

© 2001 by Intermec Technologies Corporation
All Rights Reserved

The word Intermec, the Intermec logo, MobileLAN, Data Collection PC, Tracker Antares, JANUS, IRL, Universal Access Point, UAP, TE2000, Data Collection Browser, dcBrowser, EZBuilder, and CrossBar are either trademarks or registered trademarks of Intermec Technologies Corporation.

Microsoft, MS, ActiveSync, Active Desktop, Outlook, Windows, Windows NT, and the Windows CE logo are either registered trademarks or trademarks of Microsoft Corporation in the United States and/or other countries. Microsoft products are licensed to OEMs by Microsoft Licensing, Inc., a wholly owned subsidiary of Microsoft Corporation. CIC and Jot are registered trademarks or trademarks of Communication Intelligence Corporation.

Throughout this manual, trademarked names may be used. Rather than put a trademark (™ or ®) symbol in every occurrence of a trademarked name, we state that we are using the names only in an editorial fashion, and to the benefit of the trademark owner, with no intention of infringement.

Contents

Learning About the Pocket PC 5

Getting the Pocket PC Up and Running 5

Charging the Batteries 6

Turning on Power 7

Following the Setup Wizard 7

Synchronizing With Your Desktop PC 8

Description 9

Front Panel View 9

Back Panel View 10

Left Edge View 10

Top Edge View 11

Using the Pocket PC 12

About the Today Screen 12

Using the Command Bar and the Navigation Bar 12

Using Pop-Up Menus 13

Entering Information 14

Specifications 16

Where to Find More Information 16

END-USER LICENSE AGREEMENT 17

Learning About the Pocket PC

Congratulations on purchasing the Intermec Model 70 Pocket PC powered by Microsoft® Windows® CE. This Pocket PC is the most convenient way to manage your business and personal information.

Read this guide before operating the Pocket PC.

Getting the Pocket PC Up and Running

When you remove the Pocket PC from its box, save the box and shipping material in case you need to ship or store it. Check the contents of the box against the invoice for completeness, and contact your local Intermec sales representative if there is a problem.

These items should be in the box with the Pocket PC:

- Rechargeable battery pack
- Cradle (RS-232)
- Case
- Microsoft ActiveSync CD
- Windows CE license, conformity statement, warranty card, and this *Model 70 Pocket PC Quick Start Guide*

You must order an AC adapter that is compatible with your country's wall plug style. All adapters accept 110 or 220 VAC.

Wall Plug Style	Part No.
North America	871-013-050
Europe	871-013-052
United Kingdom	871-013-051

For a list of other AC adapters and accessories that may be available, contact your local Intermec sales representative.

1 Charging the Batteries



Note: As soon as you remove the backup battery tape, connect the Pocket PC to an external power source to keep the backup battery from draining.

1. Activate the backup battery by pulling out the backup battery tape. To locate the backup battery, see “Back Panel View” later in this guide.
2. Carefully, remove the main battery door. Use your thumbs to slide the door horizontally until it unlatches and then lift the door up and away from the Pocket PC.

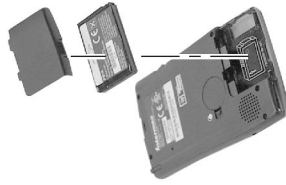

3. Insert the battery pack into the compartment. Make sure that the battery contacts are pointing toward the top edge of the Pocket PC and the battery label is facing out so that you can read it.
4. Reinsert the main battery door and slide it horizontally toward the top edge until it clicks into place.
5. You can plug the AC adapter into the Pocket PC or you can plug it into the back of the cradle and then connect it to a power outlet.



6. Dock the Pocket PC in its cradle and charge for at least 3 hours. You can use the Pocket PC while the battery is charging.

2 Turning on Power

- Press the Power button.



3 Following the Setup Wizard

1. When the Welcome screen appears, press the Action button or tap the screen with your stylus. To locate the stylus, see “Top Edge View” later in this guide. This will initiate the Setup wizard.



2. Pull the stylus out of its built-in compartment.
3. Follow the wizard's onscreen instructions as it leads you through the rest of the setup process.



Note: If you don't use the Pocket PC for several days, be sure to back up data and keep the Pocket PC connected to an external power source. Otherwise, the batteries may drain completely, resulting in data loss.

4 Synchronizing With Your Desktop PC

Using Microsoft ActiveSync, you can synchronize the data on the Pocket PC with the data on your desktop computer. ActiveSync also lets you back up and restore data, install or delete programs, and copy files to and from your desktop computer.

For help using ActiveSync, see the ActiveSync online help on your desktop computer.

To synchronize your information with your desktop computer

1. Use the cradle to establish a connection with a desktop or notebook computer.
 - a. Connect the cradle to a serial port on the desktop computer.



- b. Plug the AC adapter into the back of the cradle and connect to a power outlet.
 - c. Dock the Pocket PC in the cradle.
2. Install ActiveSync.
 - a. Insert the ActiveSync CD into your desktop computer.
 - b. Follow the onscreen instructions for installing it. When the process is complete, the Microsoft ActiveSync Get Connected dialog box appears.
 3. Follow the onscreen instructions for establishing a partnership and performing your first synchronization.



Note: It is important to back up data to your desktop computer regularly. For help, see “Backup and Restore” in the ActiveSync online help on your desktop computer.

Description

This section describes the front panel, the back panel, the left edge, and the top edge of the Pocket PC.

Front Panel View

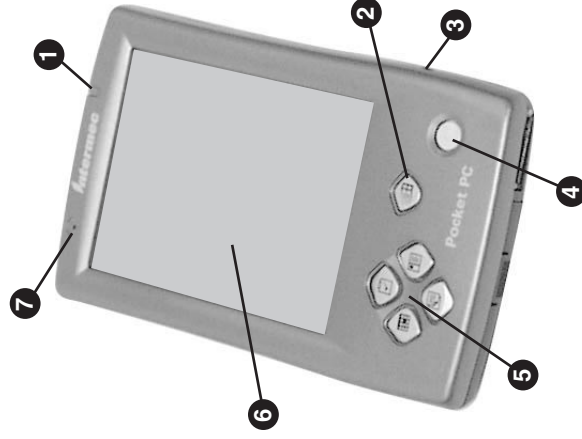

- | | | |
|---|--------------------------------|--|
| 1 | Battery Alarm and Charge Light | Provides visual alarm notification and indicates status of battery charge. |
| 2 | Windows Key | Press to maximize the Start menu. |
| 3 | DC Jack | Accommodates the DC connector of the AC adapter. |
| 4 | Power and Backlight Button | Turns the Pocket PC on and off and turns the screen backlight on and off. |
| 5 | Program Buttons | Opens frequently used applications. |
| 6 | Display | Interprets stylus taps and displays information onscreen. |
| 7 | Microphone | Lets you create voice recordings. |

Back Panel View

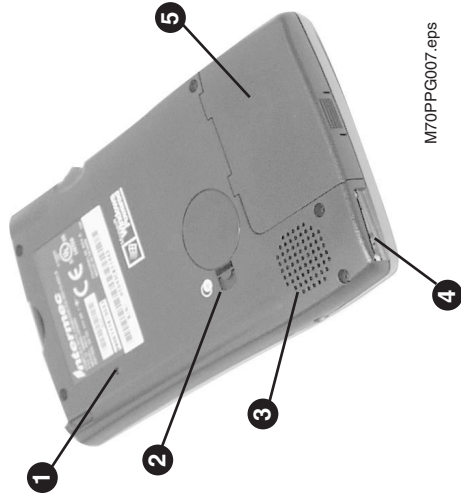

- 1 Reset Button
Press this button to restore the system after it freezes or experiences malfunction.
- 2 Backup Battery Compartment
Contains the backup battery, which provides power when the main battery is drained or removed.
- 3 Speaker
Emits recording playbacks and produces sound alarms.
- 4 Communications Port
Establishes a connection with the desktop computer through the cradle.
- 5 Main Battery Compartment
Contains the main battery pack.

Left Edge View



Left Edge View (continued)

- 1 System Manager Button
Press to activate the System Manager menu.
- 2 Action Button/Scroll Wheel
Press to open an item (similar to pressing **Enter**).
Rotate to scroll through a list (similar to using arrow keys.)
Press and hold to record voice messages.
- 3 Record Button

Top Edge View



- 1 Infrared Port
Lets you transfer data by infrared with other Windows devices.
- 2 Stylus
Use to enter information.
- 3 Compact Flash Card Slot
Holds compact flash expansion cards.
- 4 Audio Jack
Accepts a headset connection.

Using the Pocket PC

To use the Pocket PC, you need to understand the Today screen, the command bar, the navigation bar, pop-up menus, and input methods (including the Character Recognizer).

About the Today Screen

When you turn on the Pocket PC for the first time each day (or after four hours of inactivity), you will see the Today screen. You can also display this screen by tapping the Start menu or by pressing the Windows key, and then tapping Today. On the Today screen, you can see at a glance the information you need for the day.

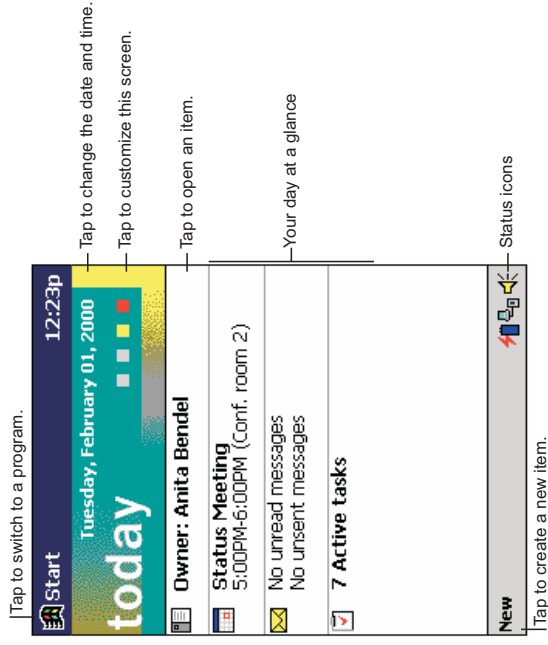

Using the Command Bar and the Navigation Bar

The command bar is displayed at the bottom of the screen. Use the menus and buttons to perform tasks in programs.

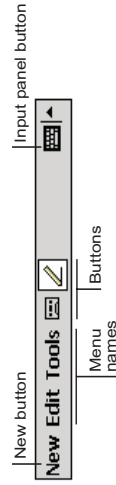

The navigation bar is located at the top of the screen. It displays the active program and current time and it lets you switch to programs and close screens.

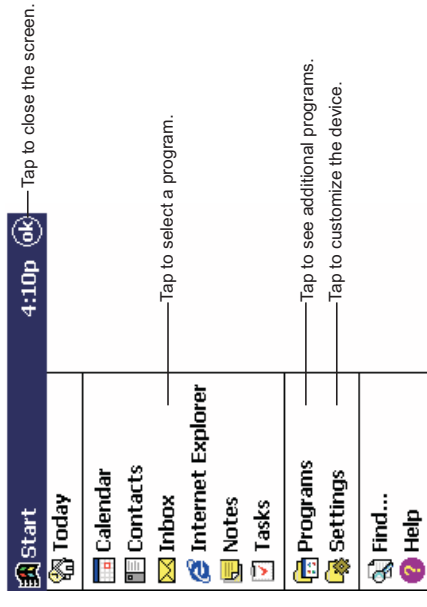

Using Pop-Up Menus

With pop-up menus, you can quickly choose an action for an item.

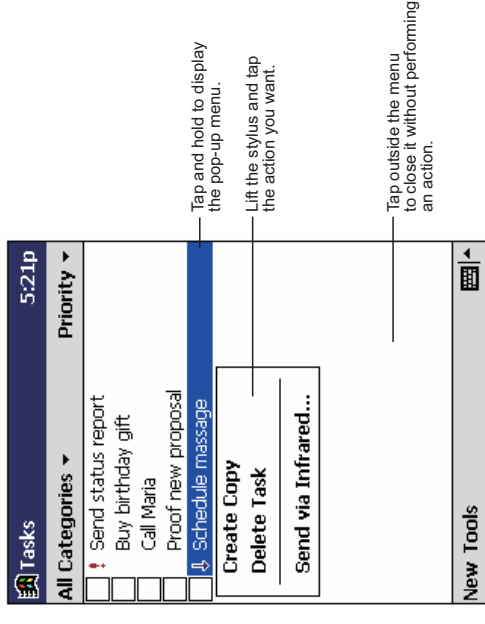

Entering Information

You can enter information in any program on the Pocket PC by typing with the soft keyboard or by writing using the Character Recognizer.

The Character Recognizer input panel is divided into three writing areas. Letters written in the left area (labeled ABC) will create uppercase letters and letters written in the middle area (labeled abc) will create lowercase letters. The right area (labeled 123) is for writing numbers, symbols, special characters, and punctuation.

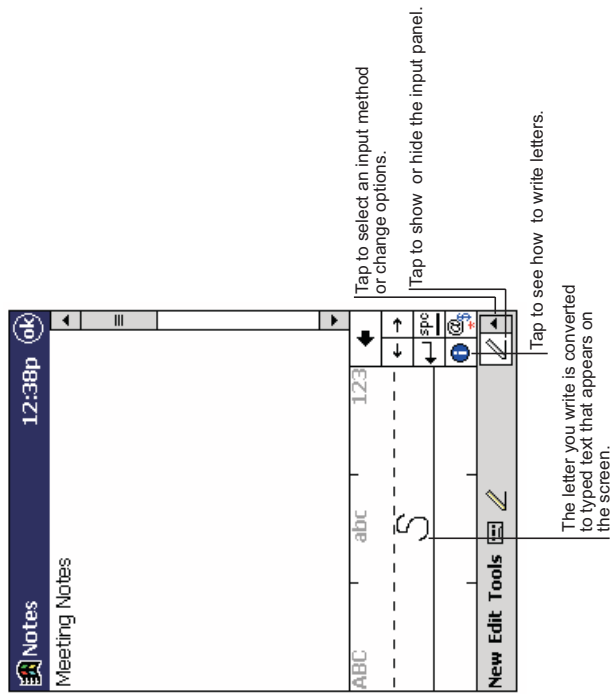

The following chart is a partial display of the characters you can write while in lowercase mode (the dot on each character is the starting point for writing). For more information on using Character Recognizer and for demonstrations of all characters, tap  on the Character Recognizer input panel.

Letter Area													Number/Punctuation Area												
A	a	a											0	0))					
B	b	b											1	1					+	+					
C	c	c											2	2					*	*	x	x			
D	d	d											3	3					/	/					
E	e	e											4	4	4	4	L		\	\					
F	f	f											5	5	5	5			?	?	?	?			
G	g	g											6	6					!	!					
H	h	h											7	7					@	@					
I	i	i											8	8					&	&	^	^			
J	j	j											9	9					^	^	^	^			
K	k	k	K	K	K	K	K	K	K	K	K	K	>	>					“	“	“	“			
L	l	l											.	.					-	-					
M	m	m											((

space	—	enter	—
back space	—	back space	—

Specifications

Physical Dimensions

Width:	8.3 cm (3.3 in)
Length:	13.8 cm (5.4 in)
Height:	1.5 cm (0.6 in)
Weight:	151.5 g (5.3 oz)

Electrical Specifications

Electrical Rating: \equiv 2A; 5 VDC

Temperature and Environmental Specifications

Operating Temperature:	0°C to 40°C	32°F to 104°F
Storage Temperature:	-25°C to 60°C	-13°F to 140°F

Relative Humidity: 0 to 95% non-condensing

Where to Find More Information

For more information on using the Model 70 Pocket PC, please see

- the *Intermec Model 70 Pocket PC User's Guide* (Part No. 961-054-025)
- the online help on the Pocket PC
- the ActiveSync online help on your desktop computer
- the Intermec Web site at www.intermec.com
- the Microsoft Web site at www.microsoft.com/mobile/pocketpc

For help with application development for the Pocket PC, please see

- the Microsoft Web site at www.microsoft.com/windows/embedded/ce/tools

END-USER LICENSE AGREEMENT

MICROSOFT WINDOWS FOR POCKET PC PROFESSIONAL EDITION 2000
DATA EXCHANGE COMPONENT: MICROSOFT ACTIVESYNC, VERSION 3.1

IMPORTANT — READ CAREFULLY: This End-User License Agreement ("EULA") is a legal agreement between you (either an individual or a single entity) and the manufacturer ("Manufacturer") of the special purpose computing device ("SYSTEM") with which you acquired the Microsoft product(s) identified above ("SOFTWARE"). The SOFTWARE includes computer software, the associated media, any printed materials, and any "online" or electronic documentation. Any software provided along with the SOFTWARE that is associated with a separate end-user license agreement is licensed to you under the terms of that license agreement. By installing, copying, downloading, accessing, or otherwise using the SOFTWARE, you agree to be bound by the terms of this EULA. If you do not agree to the terms of this EULA, Manufacturer and Microsoft Licensing, Inc. ("MS") are unwilling to license the SOFTWARE to you. In such event, you may not use or copy the SOFTWARE, and you should promptly contact Manufacturer for instructions on return of the unused product(s) in accordance with Manufacturer's return policies.

SOFTWARE LICENSE

The SOFTWARE is protected by copyright laws and international copyright treaties, as well as other intellectual property laws and treaties. The SOFTWARE is licensed, not sold.

1. **GRANT OF LICENSE.** SOFTWARE includes software already installed on the SYSTEM ("SYSTEM Software") and, if included in the SYSTEM package, software contained on the CD-ROM disc labeled "Desktop Software for Microsoft Windows CE Microsoft ActiveSync 3.1" ("Desktop Software"). This EULA grants you the following rights to the SOFTWARE:
 - **SYSTEM Software.** You may use the SYSTEM Software as installed on the SYSTEM.
 - **Desktop Software.** If Desktop Software is included with your SYSTEM, you may install and use the Data Exchange component identified above on one (1) or more computers to exchange information with one (1) or more computing devices that contain a compatible version of the Microsoft Windows CE operating system. For other software component(s) contained in the Desktop Software, you may install and use such components only in accordance with the terms of the printed or online end-user license agreement(s) provided with such component(s). In the absence of an end-user license agreement for particular component(s) of the Desktop Software, you may install and use only one (1) copy of such component(s) on the SYSTEM or a single computer with which you use the SYSTEM.
 - **Back-up Copy.** If Manufacturer has not included a back-up copy of the SYSTEM Software with the SYSTEM, you may make a single back-up copy of the SYSTEM Software. You may use the back-up copy solely for archival purposes.
 - **Microsoft Outlook 2000.** The following terms apply to your use of Microsoft Outlook 2000 (i) regardless of the information contained in "Software Installation and Use" section of the online EULA you may install one (1) copy of the Microsoft Outlook 2000 on one (1) computer to use, exchange data, share data, access, and interact with the SYSTEM, and (ii) the EULA is between Manufacturer (as defined above) and the end user — not between the PC Manufacturer and end user.

2. DESCRIPTION OF OTHER RIGHTS AND LIMITATIONS.

- **Speech/Handwriting Recognition.** If the SOFTWARE includes speech and/or handwriting recognition component(s), you should understand that speech and handwriting recognition are inherently statistical processes; that recognition errors are inherent in the processes; that it is your responsibility to provide for handling such errors and to monitor the recognition processes and correct any errors. Neither Manufacturer nor its suppliers shall be liable for any damages arising out of errors in the speech and handwriting recognition processes.
- **Limitations on Reverse Engineering, Decompilation, and Disassembly.** You may not reverse engineer, decompile, or disassemble the SOFTWARE, except and only to the extent that such activity is expressly permitted by applicable law notwithstanding this limitation.
- **Single SYSTEM.** The SYSTEM Software is licensed with the SYSTEM as a single integrated product. The SYSTEM Software installed in read-only memory ("ROM") of the SYSTEM may only be used as part of the SYSTEM.
- **Single EULA.** The package for the SYSTEM may contain multiple versions of this EULA, such as multiple translations and/or multiple media versions (e.g., in the user documentation and in the software). Even if you receive multiple versions of the EULA, you are licensed to use only one (1) copy of the SYSTEM Software.
- **Rental.** You may not rent or lease the SOFTWARE.
- **Software Transfer.** You may permanently transfer all of your rights under this EULA only as part of a sale or transfer of the SYSTEM, provided you retain no copies, you transfer all of the SOFTWARE (including all component parts, the media and printed materials, any upgrades or backup copies, this EULA and, if applicable, the Certificate(s) of Authenticity), and the recipient agrees to the terms of this EULA. If the SOFTWARE is an upgrade, any transfer must include all prior versions of the SOFTWARE.
- **Termination.** Without prejudice to any other rights, Manufacturer or MS may terminate this EULA if you fail to comply with the terms and conditions of this EULA. In such event, you must destroy all copies of the SOFTWARE and all of its component parts.

3. UPGRADES AND RECOVERY MEDIA.

- **SYSTEM Software.** If the SYSTEM Software is provided by Manufacturer separate from the SYSTEM on media such as a ROM chip, CD-ROM disc(s) or via Web download or other means, and is labeled "For Upgrade Purposes Only" or "For Recovery Purposes Only," you may install one copy of such SYSTEM Software onto the SYSTEM as a replacement copy for the existing SYSTEM Software and use it in accordance with Section 1 of this EULA.
- **Desktop Software.** If any Desktop Software component(s) is provided by Manufacturer separate from the SYSTEM on CD-ROM disc(s) or via Web download or other means, and labeled "For Upgrade Purposes Only" or "For Recovery Purposes Only," you may (i) install and use one copy of such component(s) on the computer(s) you use to exchange data with the SYSTEM as a replacement copy for the existing Desktop Software component(s).

4. **COPYRIGHT.** All title and intellectual property rights in and to the SOFTWARE (including, but not limited to, any images, photographs, animations, video, audio, music, text, and "applets" incorporated in the SOFTWARE), the accompanying printed materials, and any copies of the SOFTWARE, are owned by MS or its suppliers (including Microsoft Corporation). You may not copy the printed materials accompanying the SOFTWARE. All title and intellectual property rights in and to the content which may be accessed through use of the SOFTWARE is the property of the respective content owner and may be protected by applicable copyright or other intellectual property laws and treaties. This EULA grants you no rights to use such content. All rights not specifically granted under this EULA are reserved by MS and its suppliers (including Microsoft Corporation).
5. **EXPORT RESTRICTIONS.** You agree that you will not export or re-export the SOFTWARE to any country, person, or entity subject to U.S. export restrictions. You specifically agree not to export or re-export the SOFTWARE: (i) to any country to which the U.S. has embargoed or restricted the export of goods or services, which as of May 1999 include, but are not necessarily limited to, Cuba, Iran, Iraq, Libya, North Korea, Sudan, Syria, and the Federal Republic of Yugoslavia (including Serbia, but not Montenegro), or to any national of any such country, wherever located, who intends to transmit or transport the products back to such country; (ii) to any person or entity who you know or have reason to know will utilize the SOFTWARE or portion thereof in the design, development, or production of nuclear, chemical, or biological weapons; or (iii) to any person or entity who has been prohibited from participating in U.S. export transactions by any federal agency of the U.S. government.
6. **NOTE ON JAVA SUPPORT.** The SOFTWARE may contain support for programs written in Java. Java technology is not fault tolerant and is not designed, manufactured, or intended for use or resale on online control equipment in hazardous environments requiring fail-safe performance, such as in the operation of nuclear facilities, aircraft navigation or communication systems, air traffic control, direct life support machines, or weapons systems, in which the failure of Java technology could lead directly to death, personal injury, or severe physical or environmental damage. Sun Microsystems, Inc. has contractually obligated Microsoft Corporation to make this disclaimer.
7. **PRODUCT SUPPORT.** Product support for the SOFTWARE is not provided by MS, its parent corporation, Microsoft Corporation, or their affiliates or subsidiaries. For product support, please refer to Manufacturer's support number provide in the documentation for the SYSTEM. Should you have any questions concerning this EULA, or if you desire to contact Manufacturer for any other reason, please refer to the address provided in the documentation for the SYSTEM.

FOR THE LIMITED WARRANTIES AND SPECIAL PROVISIONS PERTAINING TO YOUR PARTICULAR JURISDICTION, PLEASE REFER TO YOUR WARRANTY BOOKLET INCLUDED WITH THIS PACKAGE OR PROVIDED WITH THE SOFTWARE PRINTED MATERIALS.

Part No. 962-054-034



962-054-034