



AG3 Protective Boot Instructions

The AG3 protective boot enhances the durability and ruggedness of the CK30 Handheld Computer.

These instructions explain how to install the boot on a CK30. Before using the protective boot, please read these instructions and save them for future reference.

Installing the Protective Boot on the CK30

The CK30 has either a wide case or a standard case, depending on the type of internal scanner that is installed. Before installing the protective boot, you need to identify which CK30 case you have.

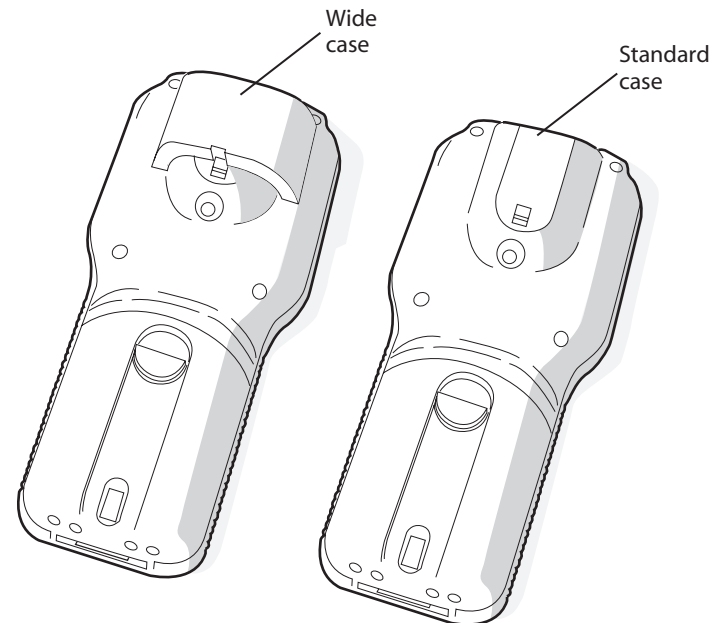

CK30 case: This illustration shows the difference between the CK30 wide case and the CK30 standard case.



Technologies Corporation

6001 36th Avenue West

Everett, WA 98203

U.S.A.

www.intermec.com

© 2004 Intermec Technologies Corp.

All Rights Reserved

AG3 Protective Boot Instructions



P/N 074299-001

To install the protective boot

- 1 If you are installing the boot on a CK30 with a wide case, you need to remove the back strap of the protective boot. Using a sharp blade, carefully cut along the groove of the back strap, and remove it.

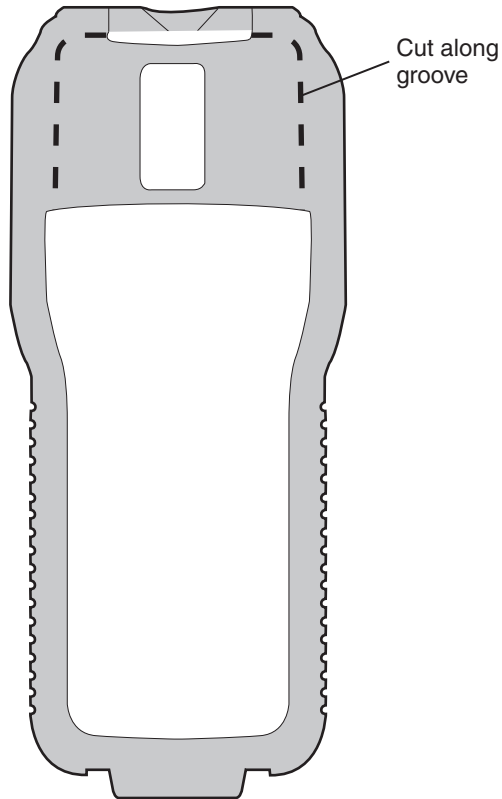

- 2 Slide the top of the CK30 into the boot, and pull the bottom of the boot over the bottom of the CK30.

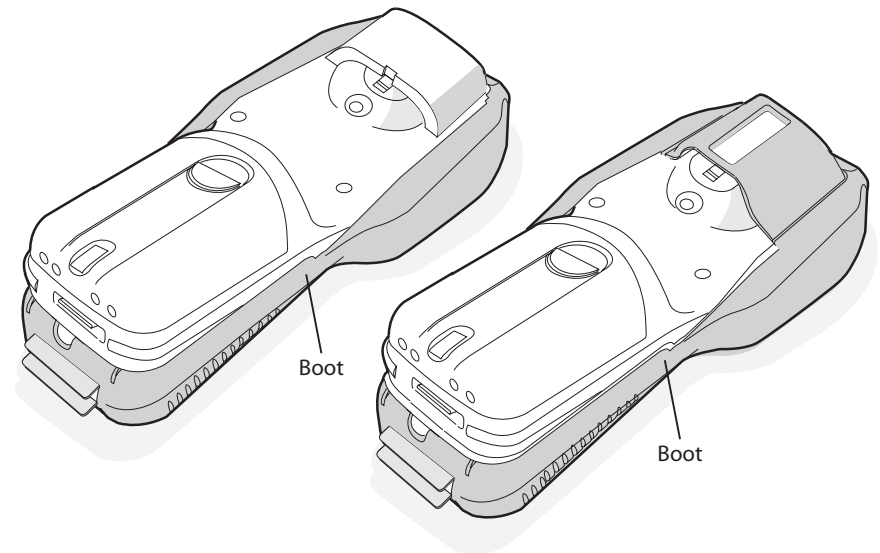

The protective boot is now securely attached to your CK30.



Note: You do not need to remove the protective boot to change the CK30 battery.