

This kit is available only to qualified modular level service providers. Reference the service manual for your product to find requirements for ElectroStatic Discharge (ESD) protection and full details regarding the removal and replacement of parts and assemblies.

These instructions explain how to install the EAS wire in either of two scanner models. Instructions specific to Magellan 2200VS scanners are shown below on the left side of the page and Magellan 2300HS scanner instructions are shown on the right.

- 1** Remove the scanner from its mounted position and disconnect all cables.

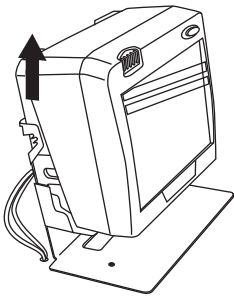

Lift the scanner straight up and out of its mount.

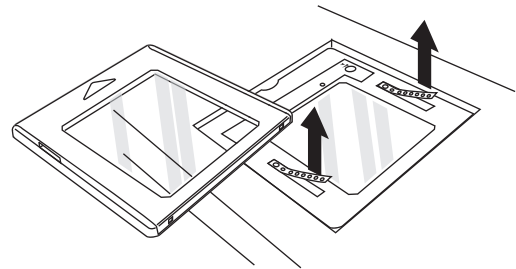

Lift off the Top Cover, then use the Lift Handles to remove the scanner from the counter.

- 2** Place the scanner face down on an ESD protected surface and detach the...

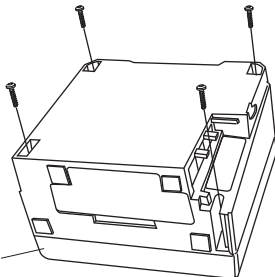

...Front Enclosure

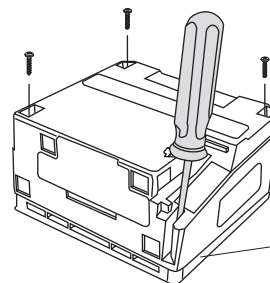

...Top Enclosure

- 3** Turn the scanner face up, lift off the Front/Top Enclosure, then remove the Chassis.

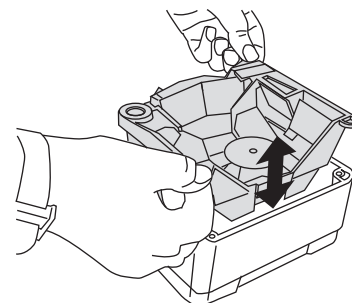
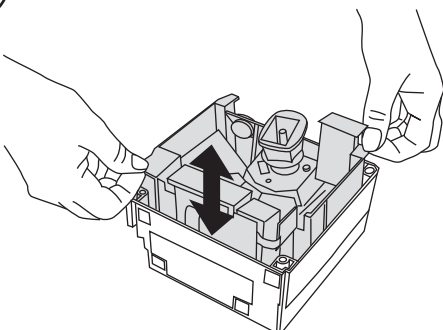

4

Peel off the EAS portion of the connector label from the Lower/Back Enclosure to expose the opening for the wire.

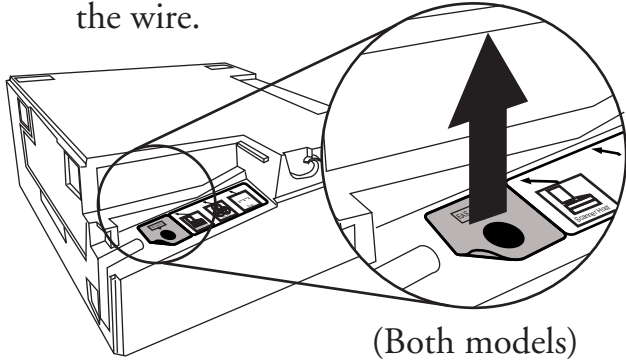

(Both models)

5

Feed the loop end of the EAS Wire through the EAS opening, then seat the rubber grommet in the hole.

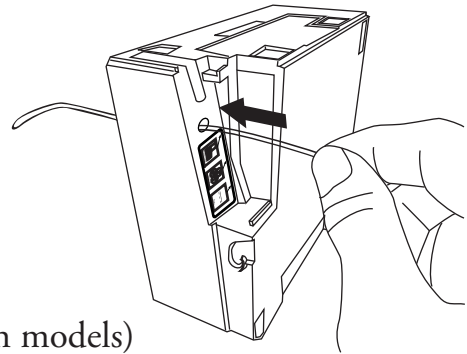

(Both models)

6

Seat the EAS Wire inside the enclosure in the guides as shown. It may be helpful to use a toothpick or similar tool to push the wire fully into position within the guides.

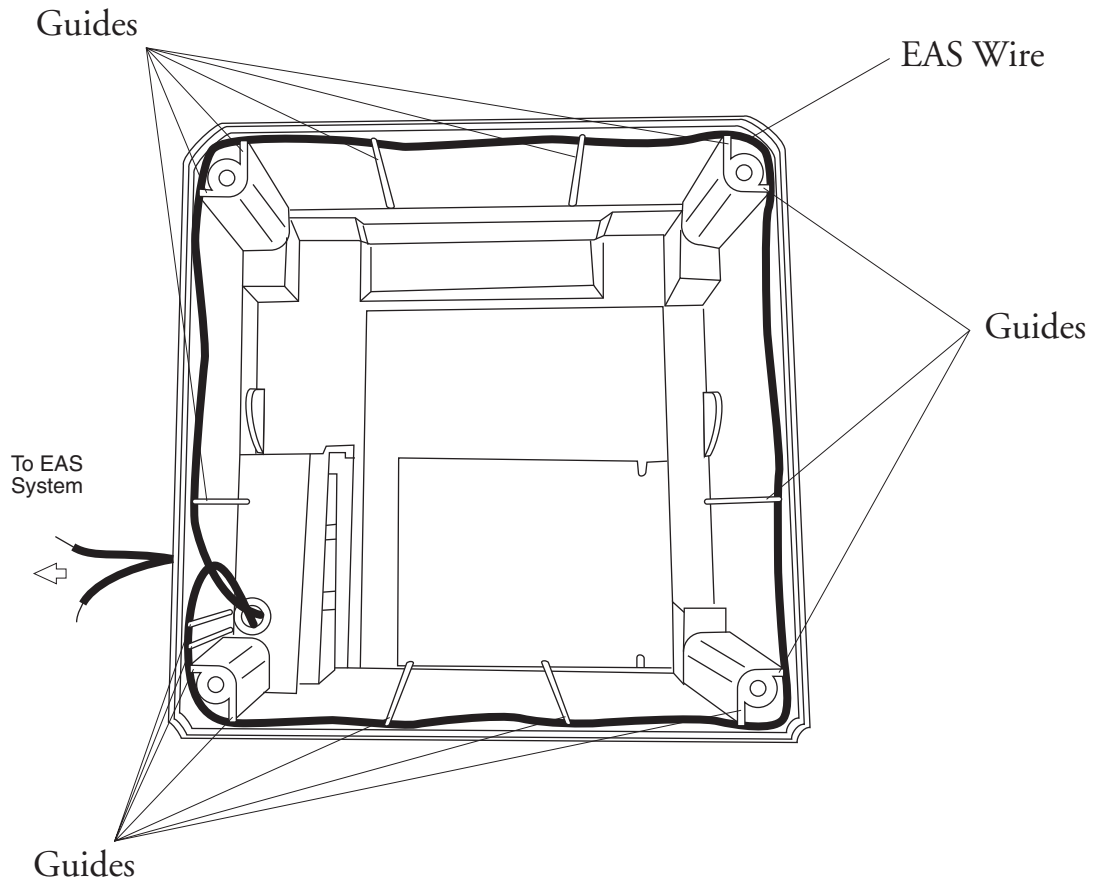

7

Reassemble and remount the scanner as described in the service manual, taking care to ensure the EAS wire remains seated in the guides. Use the other kit contents (EAS Antenna label and cable tie) at your own discretion to optimize the installation. This completes these instructions.

