

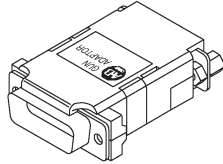

Bulletin 2755 Gun Adapter (Catalog Number 2755-NC16 Series B)

Overview



The Gun Adapter allows you to connect Allen-Bradley hand-held scanners to the Enhanced Decoders (Catalog No. 2755-DD1, -DS1). The adapter has two connectors:

- 15-pin D connector plugs into the decoder
- 9-pin D connector accepts the connector of the hand-held scanner

Applications

We recommend that you use the Gun Adapter whenever you need to:

- Use an Enhanced Decoder for both attended and unattended applications.
- Use a hand-held scanner as part of a DH485 network.
- Use discrete outputs as part of an attended application.

The following shows a typical application using a hand-held scanner (Catalog No. 2755-HUG-4).

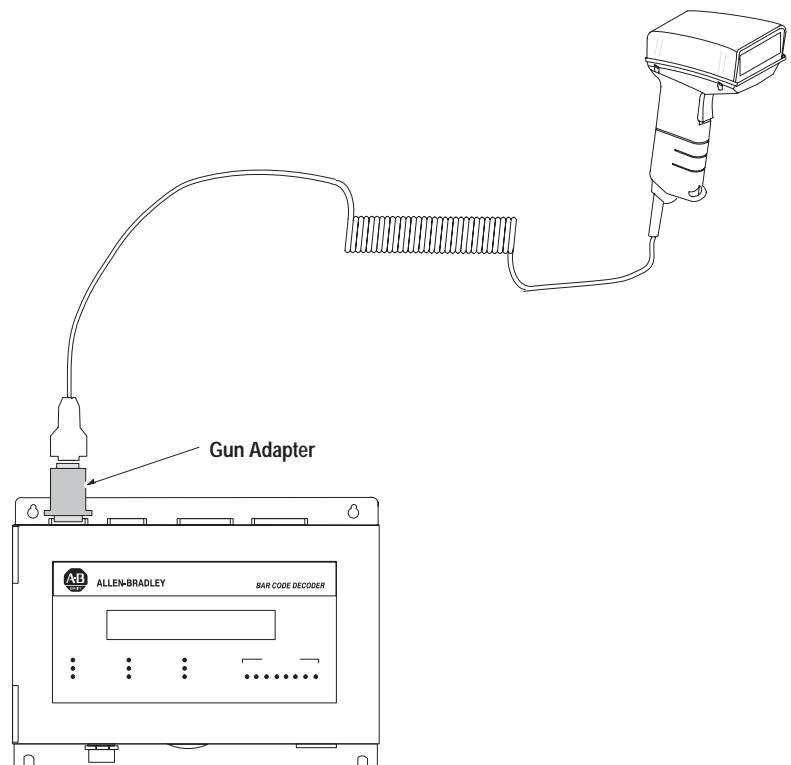

Equipment Connections

To install the Gun Adapter:

1. Make sure power to the decoder is turned off.
2. Attach the 15-pin Gun Adapter connector to the scanner connector on the decoder. Secure connector with hold-down screws.
3. Attach the scanner cable to the 9-pin Gun Adapter connector. Secure the connector with the hold-down screws.
4. Apply power to the decoder.
5. Configure the decoder for operation with the hand-held scanner as described below.

Enhanced Decoder Setup

Refer to the Enhanced Decoder user manual (Publication 2755-833). Set the following parameters:

- Response Mode = **Valid Package**
- Package Detect Input Filter = **Yes**
- Package Detect Sense = **Lo = Package**
- Laser On Mode = **Triggered**
- Decode Trigger = **Package Detect**
- No Read Timer = **8000 ms**

Specifications

Mechanical

Enclosure:	Plastic (NEMA Type 1)
Weight:	1.0 oz. (28 grams)
Environment:	Ambient temperature range, 32° to 122°F (0° to 50°C)

Dimensions

L x W x H:	2 1/4 x 1 5/8 x 11/16 in.
------------	---------------------------



Allen-Bradley, a Rockwell Automation Business, has been helping its customers improve productivity and quality for more than 90 years. We design, manufacture and support a broad range of automation products worldwide. They include logic processors, power and motion control devices, operator interfaces, sensors and a variety of software. Rockwell is one of the world's leading technology companies.



Worldwide representation.

Argentina • Australia • Austria • Bahrain • Belgium • Brazil • Bulgaria • Canada • Chile • China, PRC • Colombia • Costa Rica • Croatia • Cyprus • Czech Republic • Denmark • Ecuador • Egypt • El Salvador • Finland • France • Germany • Greece • Guatemala • Honduras • Hong Kong • Hungary • Iceland • India • Indonesia • Ireland • Israel • Italy • Jamaica • Japan • Jordan • Korea • Kuwait • Lebanon • Malaysia • Mexico • Netherlands • New Zealand • Norway • Pakistan • Peru • Philippines • Poland • Portugal • Puerto Rico • Qatar • Romania • Russia-CIS • Saudi Arabia • Singapore • Slovakia • Slovenia • South Africa, Republic • Spain • Sweden • Switzerland • Taiwan • Thailand • Turkey • United Arab Emirates • United Kingdom • United States • Uruguay • Venezuela • Yugoslavia

Allen-Bradley Headquarters, 1201 South Second Street, Milwaukee, WI 53204 USA, Tel: (1) 414 382-2000 Fax: (1) 414 382-4444